

TITLE:
PROCEDURE FOR ACCESS TO INDIVIDUAL DOSE REPORT

1. Find your dosimetry account number. Your dosimetry account number is a seven-digit number on the back of your dosimeter on the second line of text. Shown in red in Figure 1.

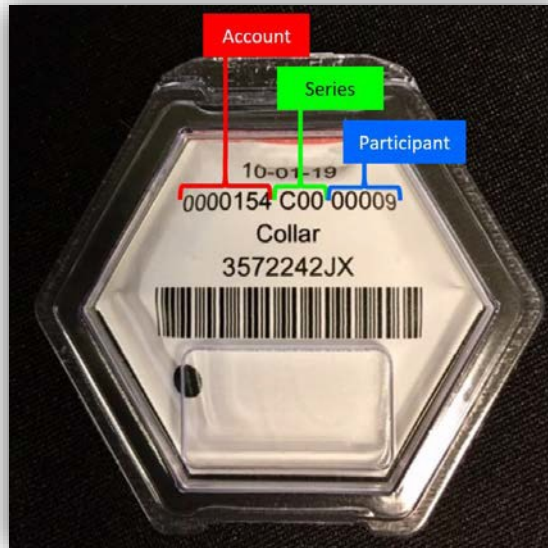

Figure 1. Account Number on Dosimeter

2. Once you have found your account number, locate your login credentials using Table 1.
 - If the account number for your dosimeters is not listed in Table 1, please contact the dosimetry program coordinator at: emorydosimeters@emory.edu.

Table 1 – Account Login Credentials

Account	Username	Password
0000154	Emory.edu	EmoryEhso2
0010792	Emory.dekalb	Radiation123%
0046434	Emory.EJCH.2	RadiationSafety2!
0179942	Emory.EJCH.1	RadiationSafety1!
0195397	Emory_SJ	Radiation123!
0720663	Emory.EJCH.3	RadiationSafety3!
0720665	Emory.EJCH.4	RadiationSafety4!
0721156	Emory.EPTC	ProtonSafety1!

TITLE:

PROCEDURE FOR ACCESS TO INDIVIDUAL DOSE REPORT

- Once you have your login credentials, go to the Landauer website and enter the credentials.

NOTE: Passwords are case sensitive.

- Landauer Website: <https://www.myldr.com/WebSelfService/>

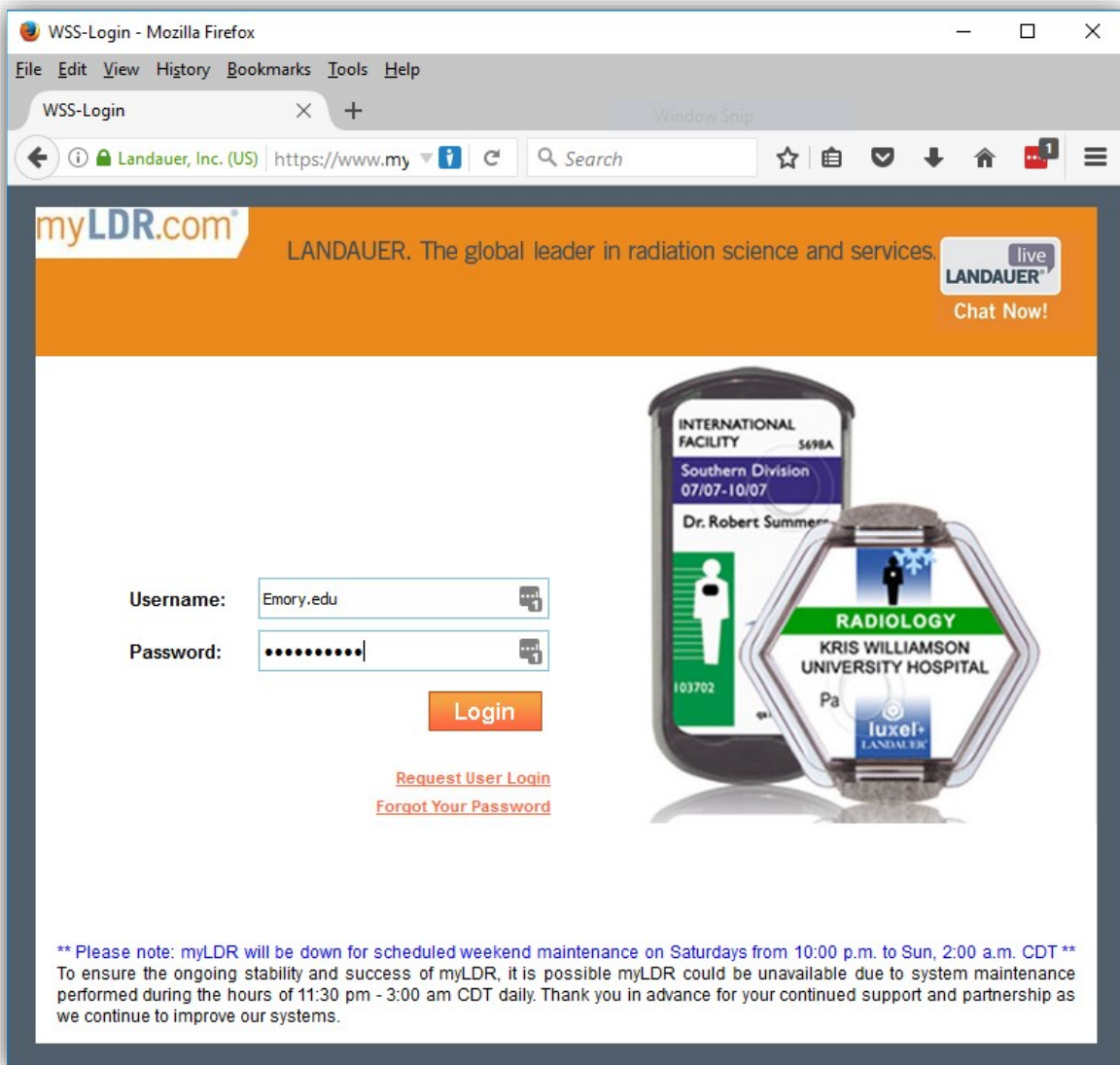

WSS-Login - Mozilla Firefox

File Edit View History Bookmarks Tools Help

WSS-Login

Landauer, Inc. (US) [https://www.my](https://www.myldr.com)

myLDR.com LANDAUER. The global leader in radiation science and services. live LANDAUER Chat Now!

Username:

Password:

Login

[Request User Login](#)

[Forgot Your Password](#)

INTERNATIONAL FACILITY 5698A
Southern Division
07/07-10/07
Dr. Robert Summer

RADIOLOGY
KRIS WILLIAMSON
UNIVERSITY HOSPITAL
Pa
luxel-
LANDAUER

103702

** Please note: myLDR will be down for scheduled weekend maintenance on Saturdays from 10:00 p.m. to Sun, 2:00 a.m. CDT **
To ensure the ongoing stability and success of myLDR, it is possible myLDR could be unavailable due to system maintenance performed during the hours of 11:30 pm - 3:00 am CDT daily. Thank you in advance for your continued support and partnership as we continue to improve our systems.

Figure 2. Login Credentials

TITLE:

PROCEDURE FOR ACCESS TO INDIVIDUAL DOSE REPORT

4. Enter your account number, leaving off the leading zeros
(See example in Figure 3) and the serial number from one of your radiation badges.

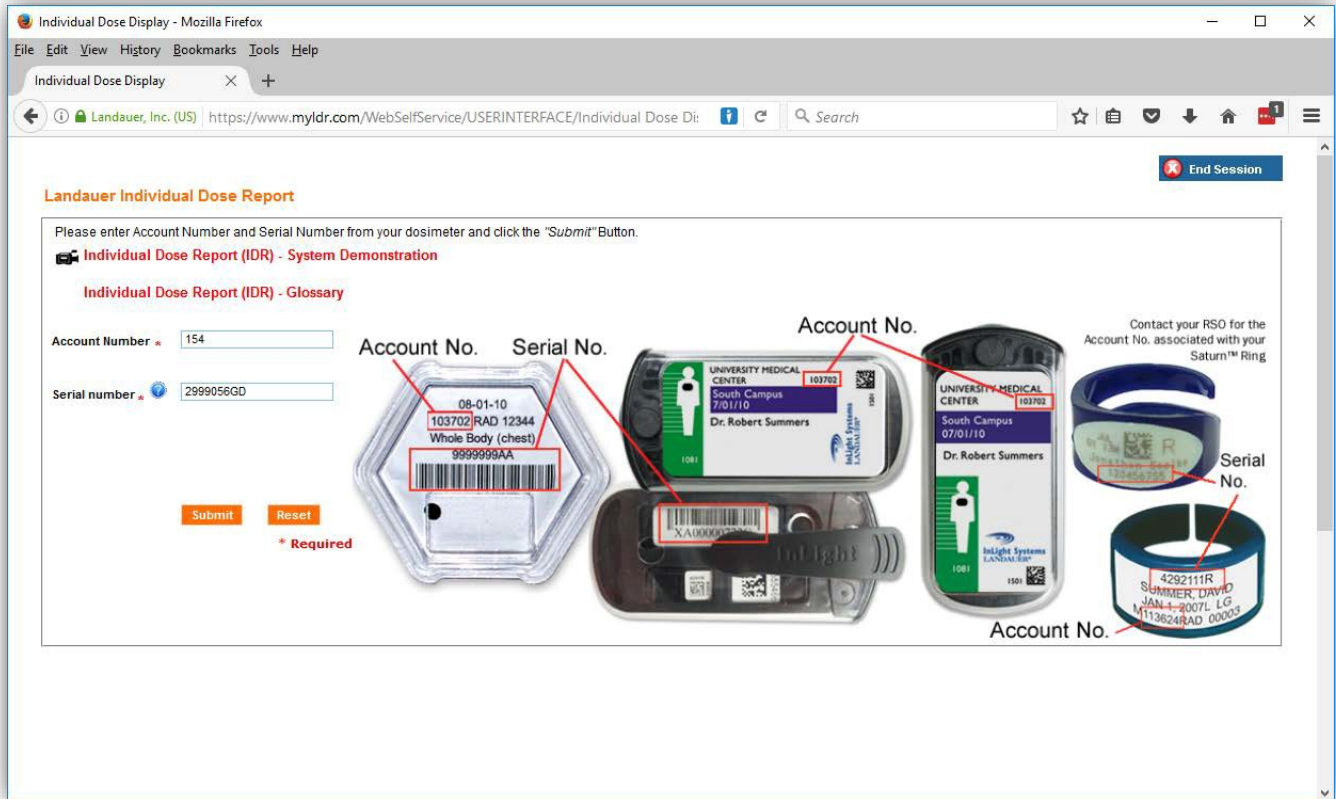
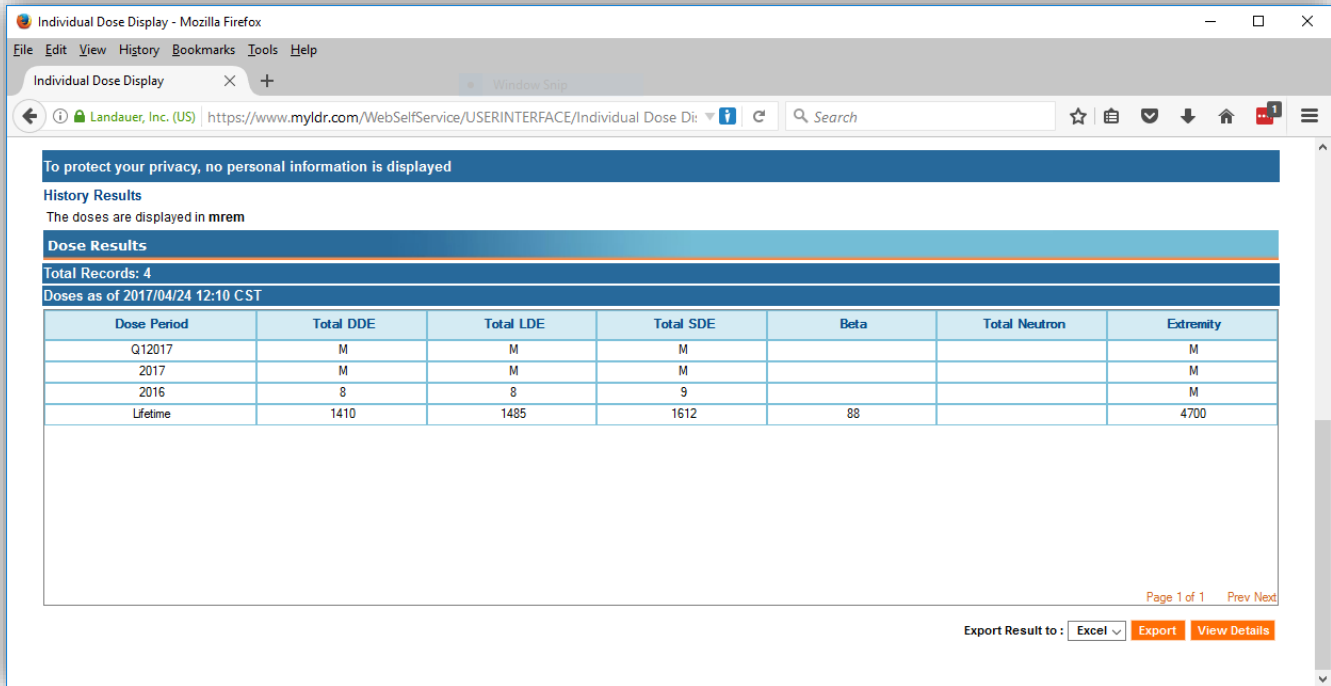

Figure 3. Login Example

TITLE:
PROCEDURE FOR ACCESS TO INDIVIDUAL DOSE REPORT

- The browser will display your dose history without any identifying data. This summary screen allows you to view your most recent quarter's results, the last 2 year's totals, and lifetime.



The screenshot shows a web browser window titled "Individual Dose Display - Mozilla Firefox". The address bar shows the URL: [https://www.myldr.com/WebSelfService/USERINTERFACE/Individual Dose Di...](https://www.myldr.com/WebSelfService/USERINTERFACE/IndividualDoseDisplay)

A blue banner at the top of the page reads: "To protect your privacy, no personal information is displayed".

Below the banner, the page is titled "History Results" and states "The doses are displayed in mrem".

The main section is titled "Dose Results" and shows "Total Records: 4". The data is as of "2017/04/24 12:10 CST".

Dose Period	Total DDE	Total LDE	Total SDE	Beta	Total Neutron	Extremity
Q12017	M	M	M			M
2017	M	M	M			M
2016	8	8	9			M
Lifetime	1410	1485	1612	88		4700

At the bottom right of the page, there is a navigation bar with "Page 1 of 1" and "Prev Next" links. Below that, there is an "Export Result to:" section with a dropdown menu set to "Excel", and buttons for "Export" and "View Details".

Figure 4. Dose History Summaries

TITLE:
PROCEDURE FOR ACCESS TO INDIVIDUAL DOSE REPORT

6. If you would like to see more detailed information, please click the View Details button. The View Details button allows the participant to see their exposure month by month for the last 2 years.

- Fetal doses are not included in this history because they do not carry assigned doses. Only the mother's doses are present. All dose information can be exported.

A	B	C	D	E	F	G	H	I	J
Account	Subaccount Name	Subaccount Code	Begin Wear Date	End Wear Date	Dosimeter Type	Dosimeter Location	Total DDE	Total LDE	Total SDE
182051	RAD	RAD	2013/01/01	2013/01/31	Pa	Chest			
182051	RAD	RAD	2012/12/01	2012/12/31	Pa	Chest			
182051	RAD	RAD	2012/11/01	2012/11/30	Pa	Chest			
182051	RAD	RAD	2012/10/01	2012/10/31	Pa	Chest			
182051	RAD	RAD	2012/09/01	2012/09/30	Pa	Chest	M	M	M
182051	RAD	RAD	2012/08/01	2012/08/31	Pa	Chest	M	M	M
182051	RAD	RAD	2012/06/01	2012/06/30	Pa	Chest	M	M	M
182051	RAD	RAD	2012/05/01	2012/05/31	Pa	Chest	M	M	M
182051	RAD	RAD	2012/04/01	2012/04/30	Pa	Chest	4	4	4
182051	RAD	RAD	2012/03/01	2012/03/31	Pa	Chest	4	4	4
182051	RAD	RAD	2012/02/01	2012/02/29	Pa	Chest	3	3	2
182051	RAD	RAD	2012/01/01	2012/01/31	Pa	Chest	M	M	M
182051	RAD	RAD	2011/12/01	2011/12/31	Pa	Chest	M	M	M
182051	RAD	RAD	2011/11/01	2011/11/30	Pa	Chest	29	29	29
182051	RAD	RAD	2011/10/01	2011/10/31	Pa	Chest	M	M	M
182051	RAD	RAD	2011/09/01	2011/09/30	Pa	Chest	29	29	27
182051	RAD	RAD	2011/08/01	2011/08/31	Pa	Chest	31	31	31
182051	RAD	RAD	2011/07/01	2011/07/31	Pa	Chest	M	M	M
182051	RAD	RAD	2011/06/01	2011/06/30	Pa	Chest	M	M	M
182051	RAD	RAD	2011/05/01	2011/05/31	Pa	Chest	M	M	M
182051	RAD	RAD	2011/04/01	2011/04/30	Pa	Chest	33	33	32
182051	RAD	RAD	2011/03/01	2011/03/31	Pa	Chest	35	35	33
182051	RAD	RAD	2011/02/01	2011/02/28	Pa	Chest	35	35	33
182051	RAD	RAD	2011/01/01	2011/01/31	Pa	Chest	42	42	40

Figure 5. Detailed Dose History